

Brick tray

T section range Soldier or Gauged brick 215 mm high

Section at span

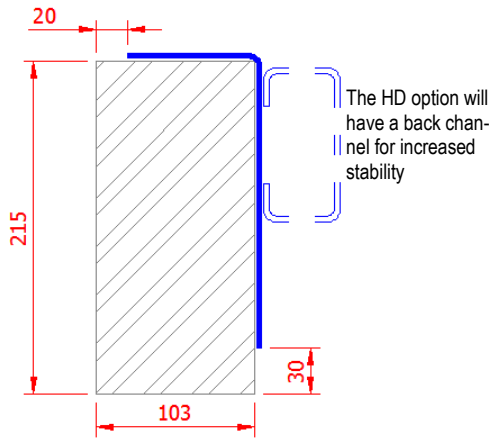

Section at bearing

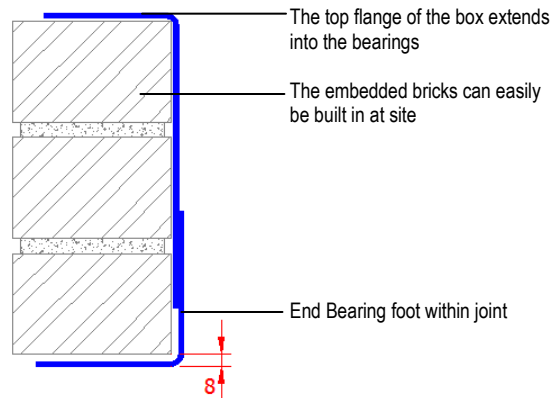

T215/3

Lintel section properties	
Ixx	320.5576 cm ⁴
Zxx	26.07 cm ³
Weight	6.51 kg/m
Area	8.14 cm
Ryy	2.42 cm

T215/4

Lintel section properties	
Ixx	431.0153 cm ⁴
Zxx	34.95 cm ³
Weight	8.70 kg/m
Area	10.88 cm
Ryy	2.44 cm

T215/6

Lintel section properties	
Ixx	657.2241 cm ⁴
Zxx	53.00 cm ³
Weight	13.13 kg/m
Area	16.41 cm
Ryy	2.48 cm

T215/4-HD

Lintel section properties	
Ixx	582.6099 cm ⁴
Zxx	45.01 cm ³
Weight	15.91 kg/m
Area	19.89 cm
Ryy	3.16 cm

Lintel load Capacity Table

Opening Span	Lintel Length	Safe Load kN
600	900	40.0
900	1200	26.6
1200	1500	20.0
1500	1800	16.0
1800	2100	13.3
2100	2400	11.4
2400	2700	10.0

Lintel load Capacity Table

Opening Span	Lintel Length	Safe Load kN
600	900	53.6
900	1200	35.7
1200	1500	26.8
1500	1800	21.4
1800	2100	17.9
2100	2400	15.3
2400	2700	13.4
2700	3000	11.9

Lintel load Capacity Table

Opening Span	Lintel Length	Safe Load kN
600	900	81.3
900	1200	54.2
1200	1500	40.6
1500	1800	32.5
1800	2100	27.1
2100	2400	23.2
2400	2700	20.3
2700	3000	18.1
3000	3300	16.3
3300	3600	14.8

Lintel load Capacity Table

Opening Span	Lintel Length	Safe Load kN
600	900	69.0
900	1200	46.0
1200	1500	34.5
1500	1800	27.6
1800	2100	23.0
2100	2400	19.7
2400	2700	17.3
2700	3000	15.3
3000	3300	13.8
3300	3600	12.5

Our unique bearings allow site brickwork to be build butting the lintel, this system gives both a high and low level bearing.

The section provides a bearing on the top flange with a second bearing at the "foot". The bricks at the bearing also fully fill between the top and bottom bearing.

Loadings are shown above to assist you in your selection 102.5mm brickwork is 2.2 kN/m² 215mm dimensions can be varied to suit imperial and other brick sizes